

Easy-Build Barn Door

DOOR ASSEMBLY INSTRUCTIONS

Skill Level: **Easy**



MKT03719

PLEASE READ CAREFULLY

- Read all instructions carefully
- Protect your eyes by wearing safety goggles
- Keep the installation area free of clutter
- Follow each step completely before starting the next step

TOOLS REQUIRED (NOT PROVIDED)

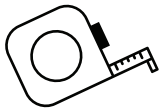

Tape Measure

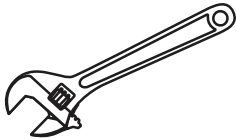

Adjustable Wrench

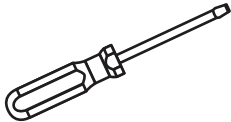

Flat Head Screwdriver

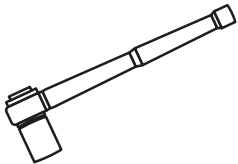

Deep Socket Wrench
11/16 inch

ASSEMBLY

Skill Level

Easy

Weight



Time



1 HOUR

People

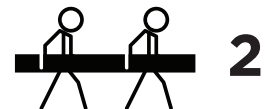

IMPORTANT!

VERIFY THAT ALL PARTS ARE INCLUDED IN THE PACKAGING. IF ANY PARTS ARE MISSING, DO NOT RETURN THIS PRODUCT TO THE STORE.
 FOR ANY PARTS ASSISTANCE, PLEASE CALL 1-800-493-5263 BETWEEN 8:30 AM - 4:30 PM EST, MONDAY TO FRIDAY
 LANGUAGE: English, French and Spanish

PACKAGE CONTENTS

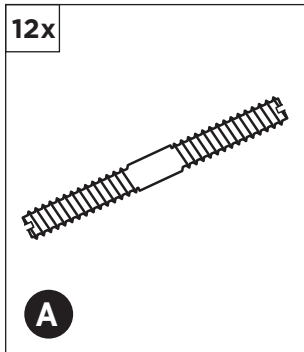

Double End Bolt

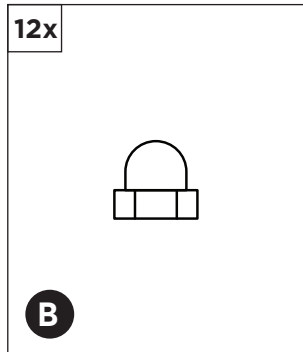

Acorn Nut

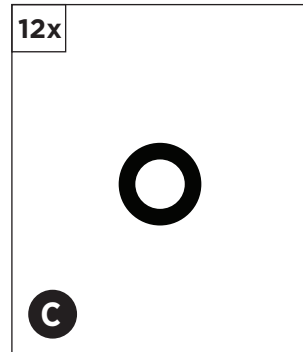

Washer

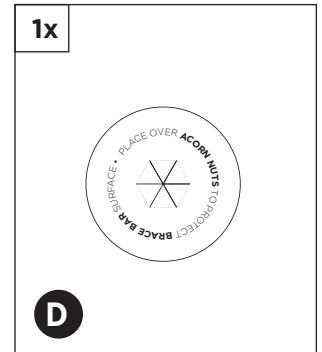

Scratch Shield (cut out of package)

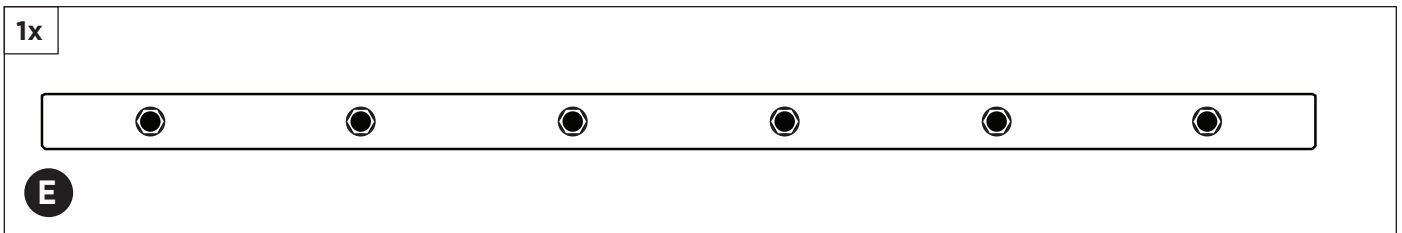

Horizontal Brace Bar (with pre-welded Acorn Nuts)

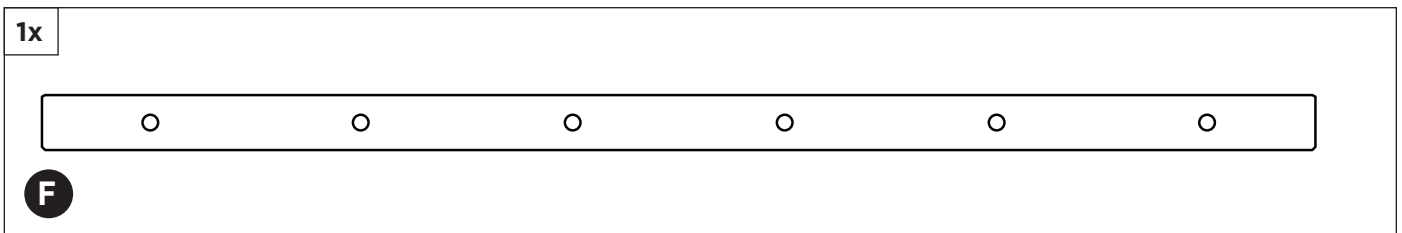

Horizontal Brace Bar (Pre-Drilled)

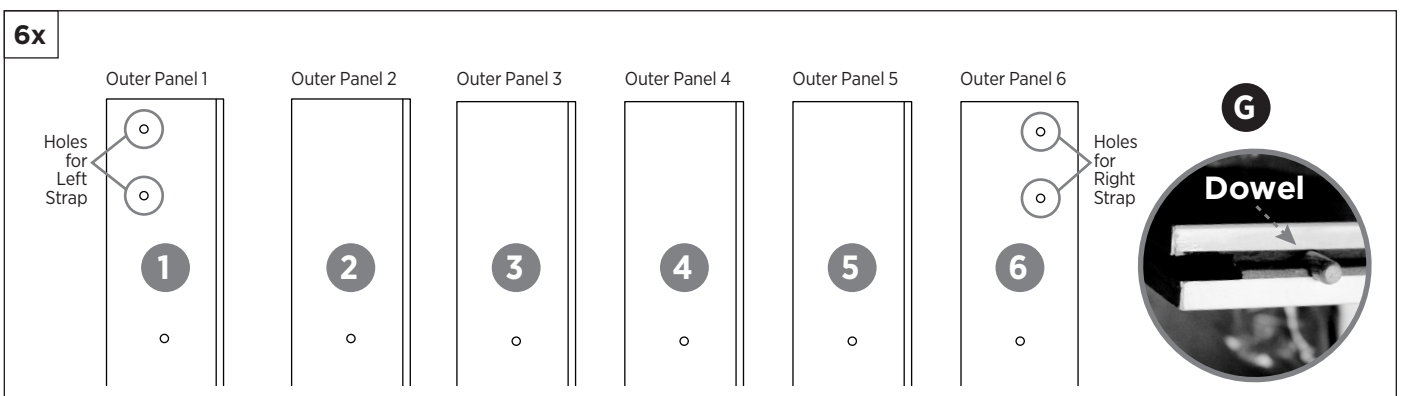

Panels with (G) Dowel

STEP 1 Prepare your assembly area

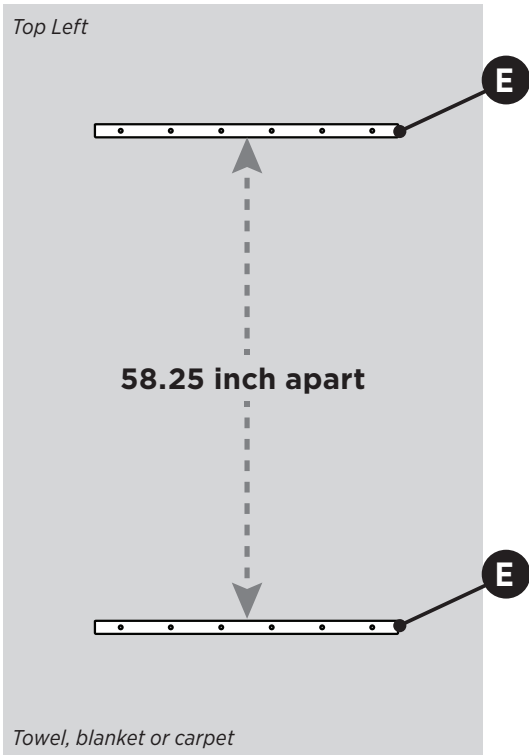

- Place both (E) Horizontal Brace Bars with pre-welded Acorn Nuts facing the ground, approximately 58.25 inch apart.

HINT

Assemble Door on a protective surface such as a towel, blanket or carpet.

STEP 2 Screw in the first Double End Bolt

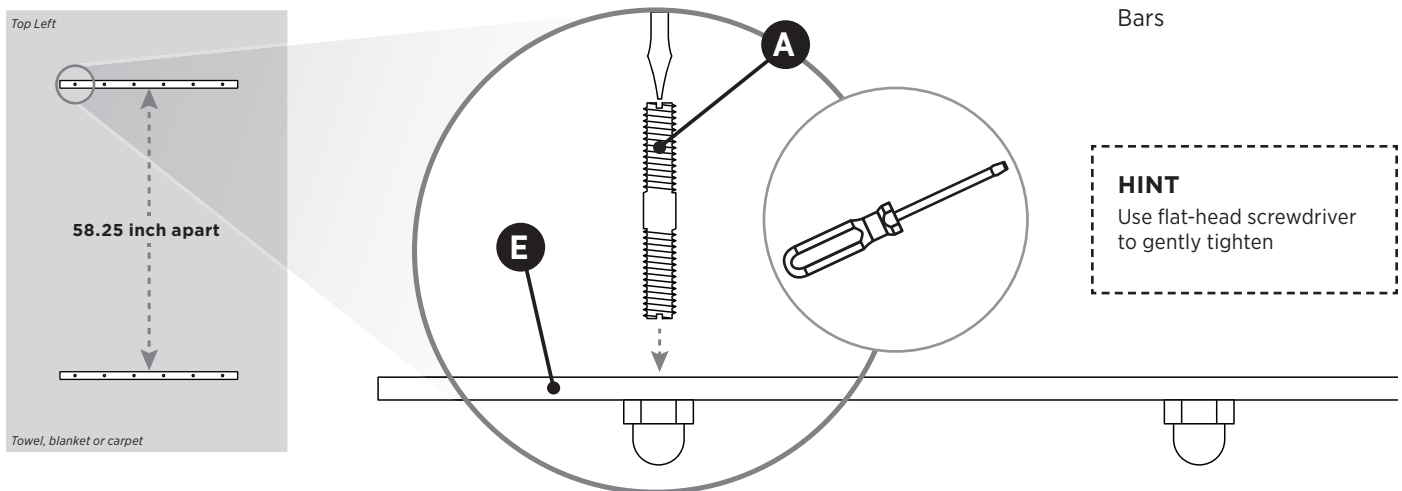

- Screw in the first (A) Double End Bolt into the very first hole (left side) of both (E) Horizontal Brace Bars

HINT

Use flat-head screwdriver to gently tighten

STEP 3 Place first Panel

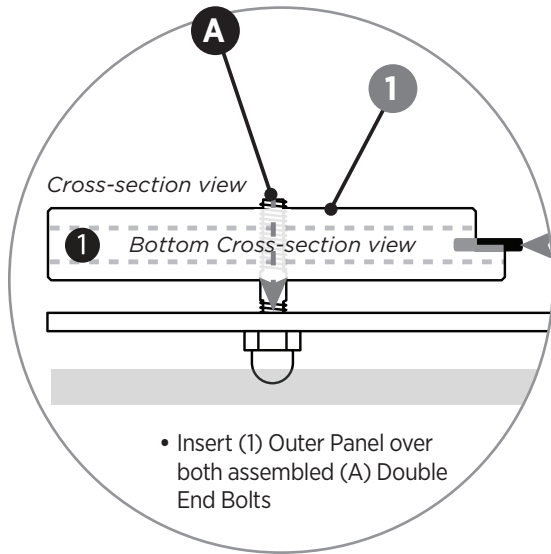

STEP 4 Place second Panel

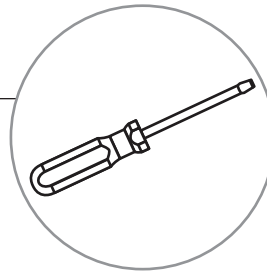
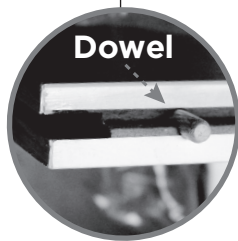
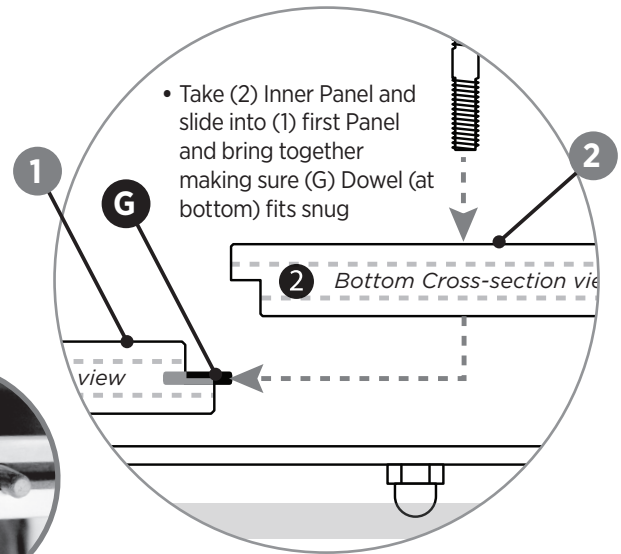

STEP 5 Place Bolts into Panel

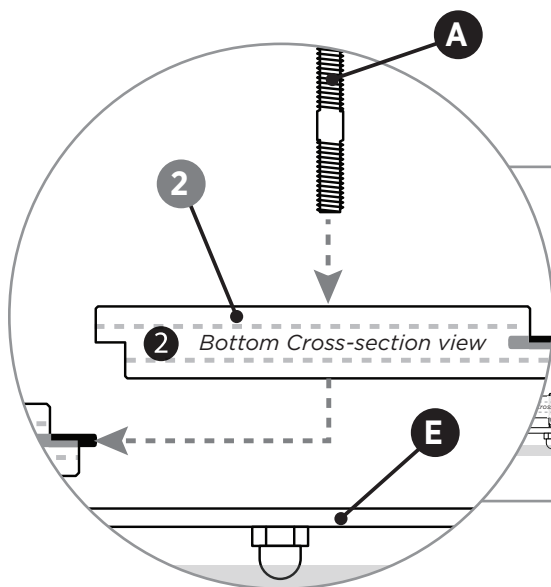

- Take (A) Double End Bolts and screw through (2) Panel into both (E) Horizontal Brace Bars
- Repeat Steps 4 and 5 from left to right until all Panels are connected

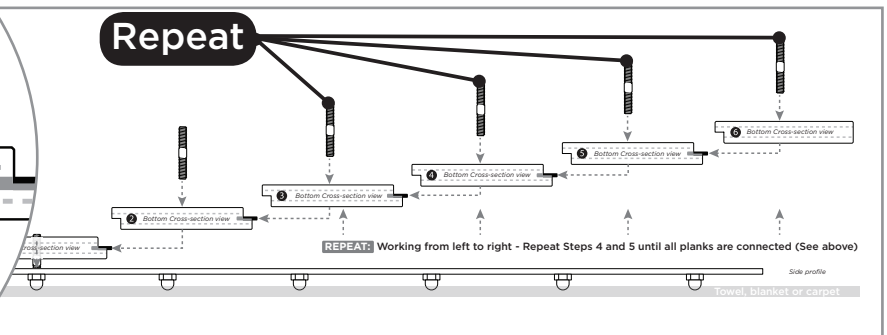

HINT

Holes on Panel and Brace Bar should be aligned.
Use flat-head screwdriver to gently tighten

STEP 6 Placing (Pre-Drilled) Horizontal Brace Bar

- Place (F) Horizontal Brace Bar (Pre-Drilled) through all 6 exposed (A) Double End Bolts and place (C) Washers and (B) Acorn Nuts

STEP 7 Secure the 1st Panel

- Using the (D) Scratch Shield placed over the (B) Acorn Nut, tighten - with 11/16" (17mm) deep Socket Wrench - the first (B) Acorn Nut on both (F) Horizontal Brace Bars on the first (1) Panel

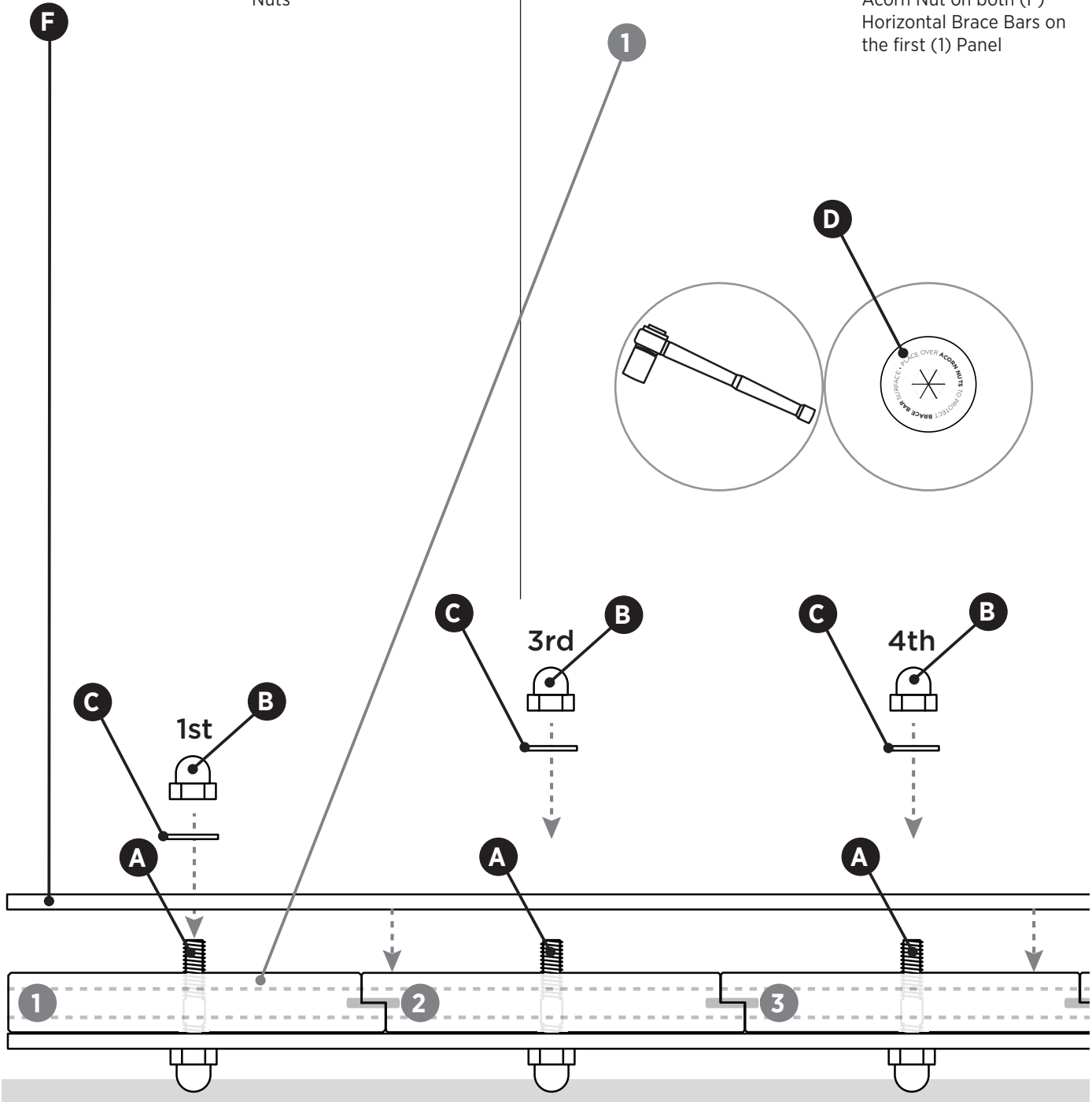

STEP 8 Repeat

- Repeat step 7 on Panel (6) (A) Double End Bolts (Right side)

HINT
only gently hand tighten

STEP 9 Press Panels together

- Press together all the Panels into Panel (1) until they are tight, place (C) Washers and (B) Acorn Nuts on both Panel (6), (A) Double End Bolts and tighten them.

HINT
Tighten - with 11/16" (17mm) deep Socket Wrench and use the protective (D) Scratch Shield

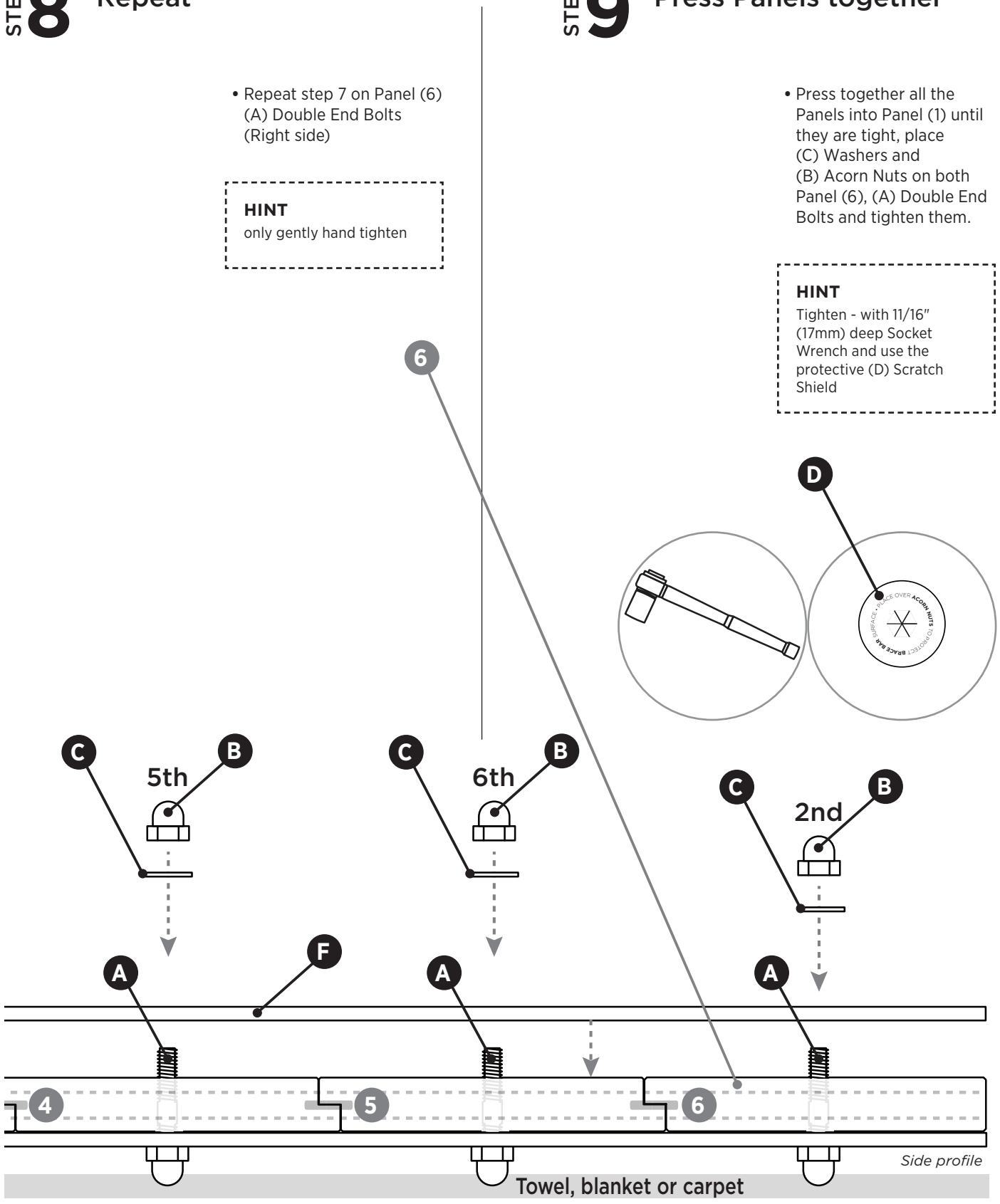

STEP 10 Finish the job

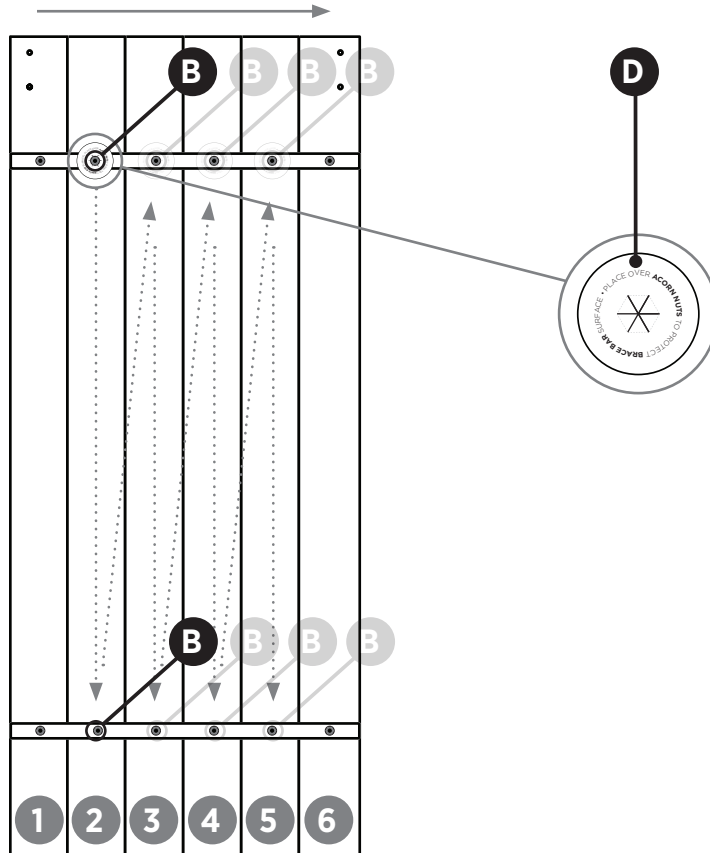

- Commence tightening the rest of the (B) Acorn Nuts using (D) Scratch Shield, tightening both (B) Acorn Nuts on each Panel - working from right to left

HINT
Tighten - with 11/16" (17mm) deep Socket Wrench and use the protective (D) Scratch Shield

You did it! Enjoy your new Renin Barn Door

5 YEAR LIMITED WARRANTY

Renin warrants their products against manufacturer's defects for up to five (5) years from the purchase date. The warranty applies only to the original purchaser of the product from Renin.

If a product is determined to be defective due to a manufacturers defect, Renin will supply a replacement product. The scope of the warranty is limited to replacing the product and does not include labor to install, repair, deliver, or any costs to remove the existing product.

This warranty is void in the event the product is damaged in transit, or if damage or failure is caused by abuse, misuse, storage of products in an improper environment, abnormal usage, faulty installation, failure to follow installation instructions, damage in an accident, improper maintenance, or any repair.

Renin reserves the right to inspect any claim prior to issuing credit.



1141 RYDER STREET
TUPELO, MS 38804

110 WALKER DRIVE
BRAMPTON, ON L6T 4H6

T. 800-493-5263
F. 905-791-7930

W. RENIN.COM
E. INFO@RENINCORP.COM

Follow Us

